



CMAX-HM4-30-I53 and CMAX-HM4-60-I53 Antennas



**CMAX-HM4-30-I53
CMAX-HM4-60-I53**

**Document Number: M0149AM
Document Revision: 04**

Date: July 2025

Copyright © 2025 ANDREW[®], an Amphenol company. All Rights Reserved.

This document has been developed by ANDREW, an Amphenol company, and is intended for the use of its customers and customer support personnel. The specifications and information regarding the products in this manual are subject to change without notice. All statements, information, and recommendations in this manual are believed to be accurate but are presented without warranty of any kind, express or implied. Users must take full responsibility for their application of any products.

The software license and limited warranty for the accompanying product are set forth in the information packet that shipped with the product and are incorporated herein by reference. If you are unable to locate the software license or limited warranty, contact your ANDREW sales representative for a copy.

Andrew Wireless Systems GmbH, 30-July-2025

TABLE OF CONTENTS

1. INSTALLATION	4
1.1. IMPORTANT INSTALLATION INFORMATION	4
1.2. ASSEMBLY	4
1.3. WALL MOUNTING	5
1.4. POLE MOUNTING	6
1.5. ANTENNA MOUNTING	7
1.6. AZIMUTH ANGLE	8
1.7. ELEVATION ANGLE	8
1.8. OPTIONAL POLE MOUNTING KIT	9
1.9. OUTDOOR INSTALLATION	10
2. CONTACTING ANDREW	11
2.1. TECHNICAL SUPPORT	11
2.2. WASTE ELECTRICAL AND ELECTRONIC EQUIPMENT RECYCLING	11
2.3. TECHNICAL TRAINING	12
2.4. ACCESSING USER DOCUMENTATION	12

LIST OF CHANGES

Version	Changes	Release Date
M0149AMD		17-July-2020
M0149AME	Branding and contact information updated Discontinued antenna types deleted	30-July-2025

1. Installation

1.1. Important Installation Information

- Please read the complete description before starting the installation.
- Be sure that connectors are properly sealed from water if no cables are connected to them after installation.
- Tools required: Wrenches, width 10 mm (we recommend using socket wrenches).



1.2. Assembly

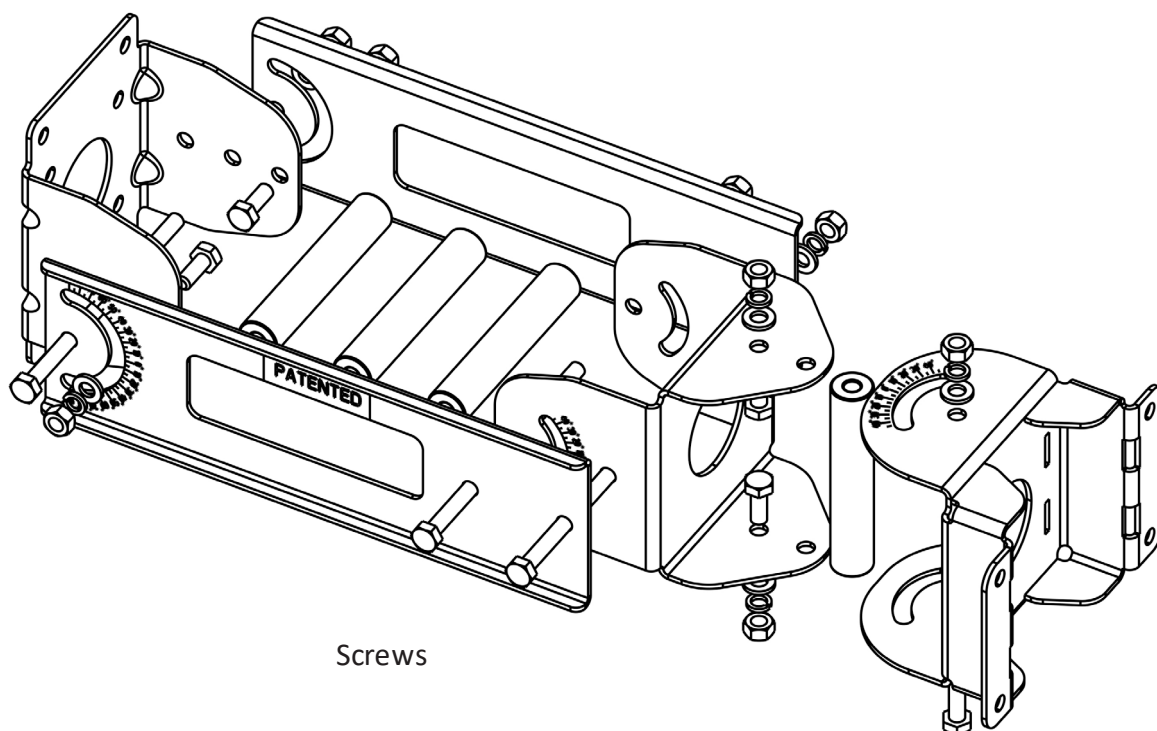
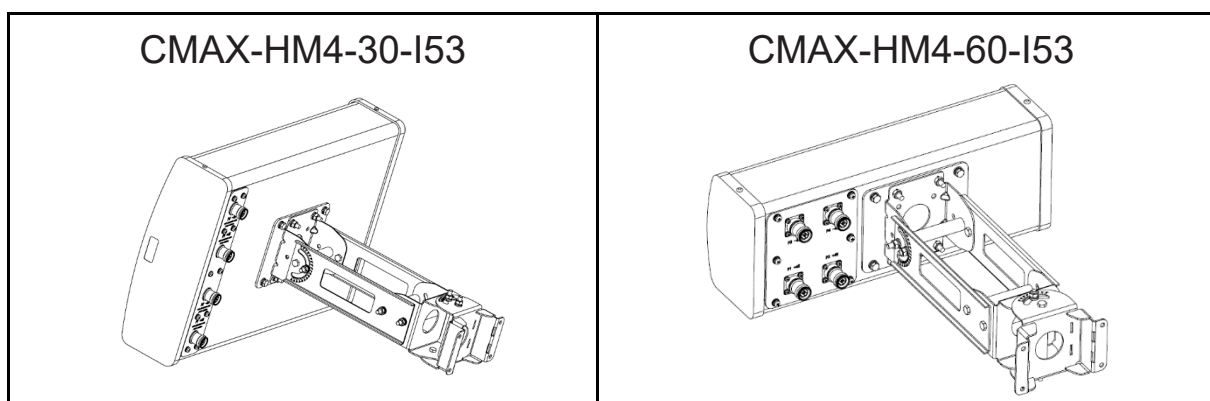

Fit the nine parts together and fasten with screws M6, nuts M6, spring washers, and washers. (M6 torque: 12Nm).

1.3. Wall Mounting

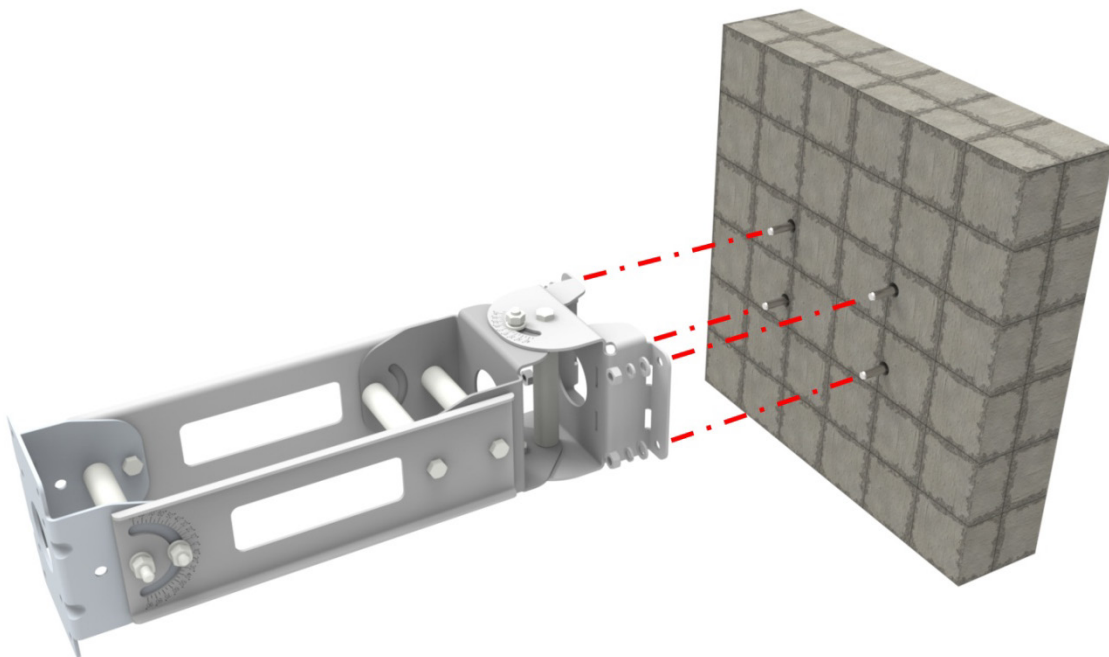
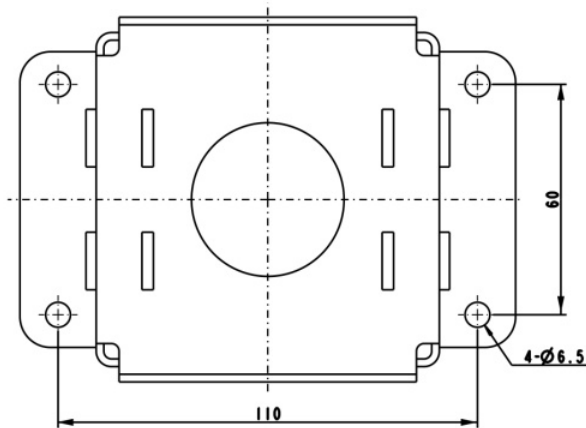

1. Use the pedestal piece to mark 4 holes onto the wall as shown in the drawing above or use a drill jig.
2. Drill 4 holes into the wall and insert appropriate anchor bolt into holes.
3. Attach the complete bracket with appropriate washers and nuts M6 (not part of the delivery).

1.4. Pole Mounting

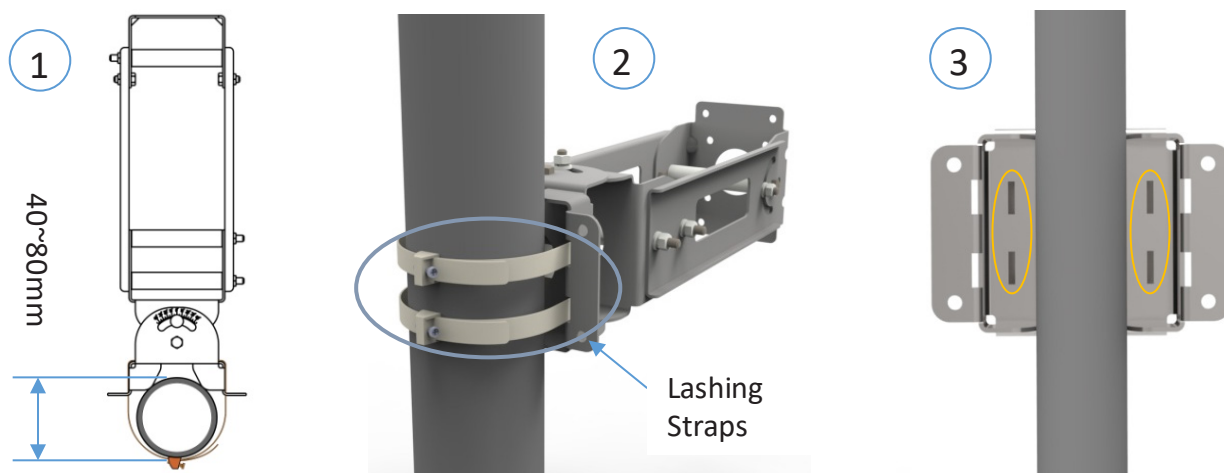

1. Lay proper lashing straps around pole and lead them through mounting bracket (1).
2. Adjust bracket in antenna direction and fasten the bracket (2).
3. For poles with a smaller diameter use the closer holes (3).

1.5. Antenna Mounting

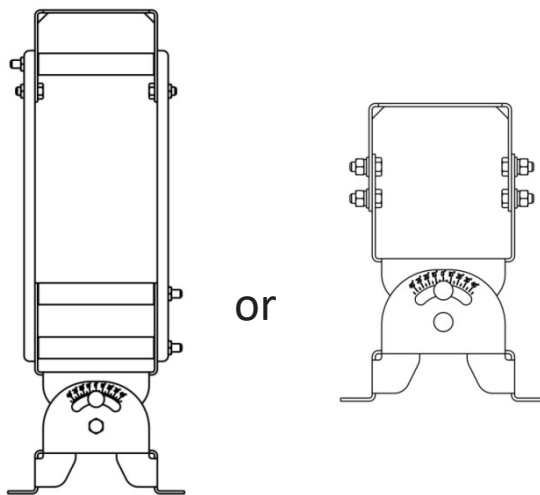

Depending on the space required for the antenna, the distance from the wall can be decreased with the lengthening piece.

Take out the lengthening piece, if the antenna is small enough.

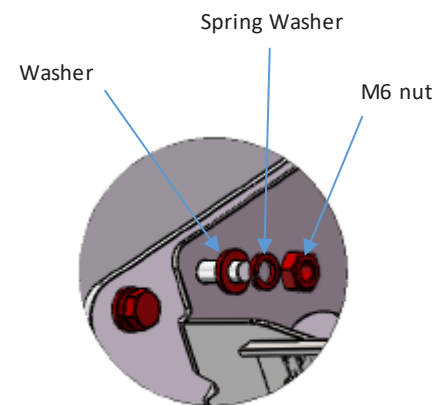
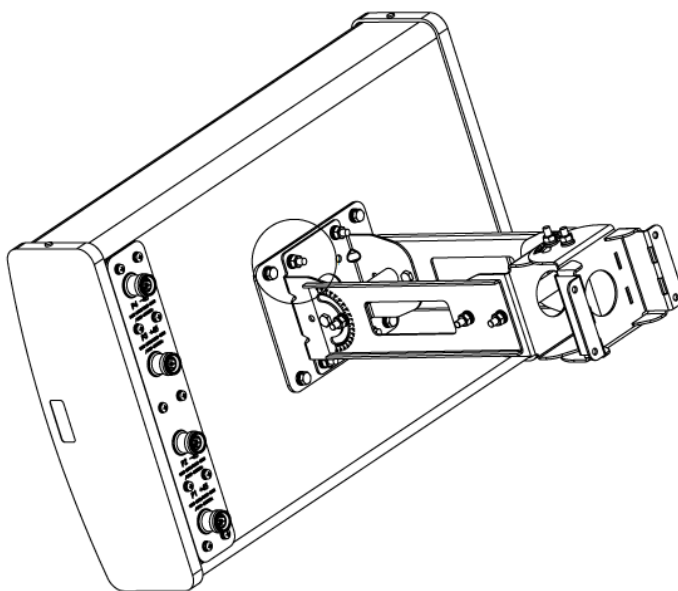

Screw joint antenna-bracket

Attach antenna and fasten it with washers and M6 nuts (M6 torque: 12 Nm).

1.6. Azimuth Angle

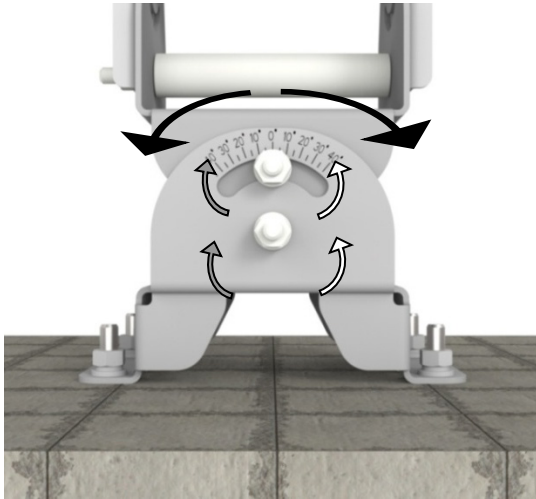

1. Loosen the three fixing screws (Top and bottom). (Do NOT unscrew them completely.)

2. Adjust your desired angle. The complete antenna pedestal can be swiveled to the left- / right-hand side by up to 45°.

3. Tighten the fixing screws.

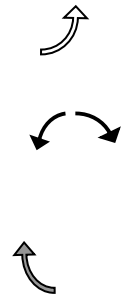

1.7. Elevation Angle

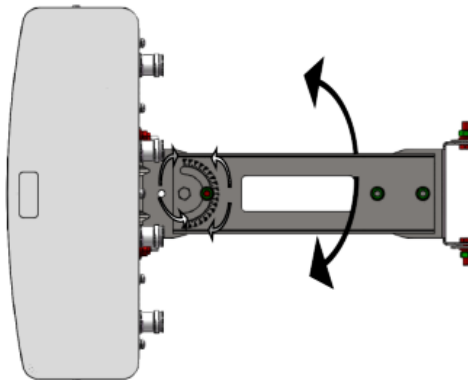

With lengthening piece :

1. Loosen the three fixing screws at the left and right-hand side. (Do NOT unscrew them completely.)

2. Adjust your desired angle. The complete antenna pedestal can be swiveled to the top / bottom by up to 90°.

3. Fasten the fixing screws.

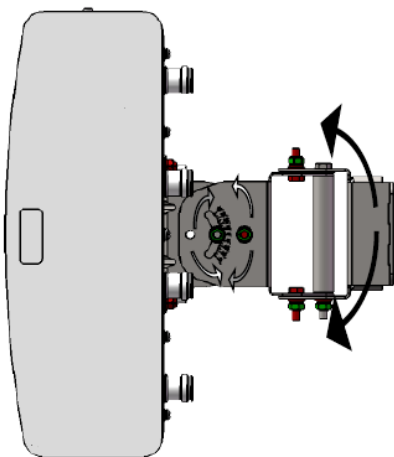
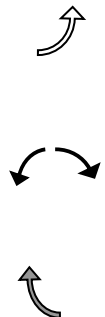

Without lengthening piece :

1. Loosen the three fixing screws at the left and right-hand side. (Do NOT unscrew them completely.)

2. Adjust your desired angle. The complete antenna pedestal can be swiveled to the top / bottom by up to 90°.

3. Fasten the fixing screws.

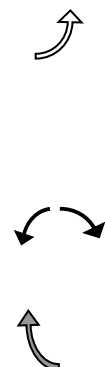

1.8. Optional Pole Mounting Kit

Optionally, a pole-mounting kit can be ordered separately from the supplier (ID 7837870).

The recommended pole diameter for this mounting kit is 40-80mm. To mount an antenna to a pole using this kit, proceed as follows:

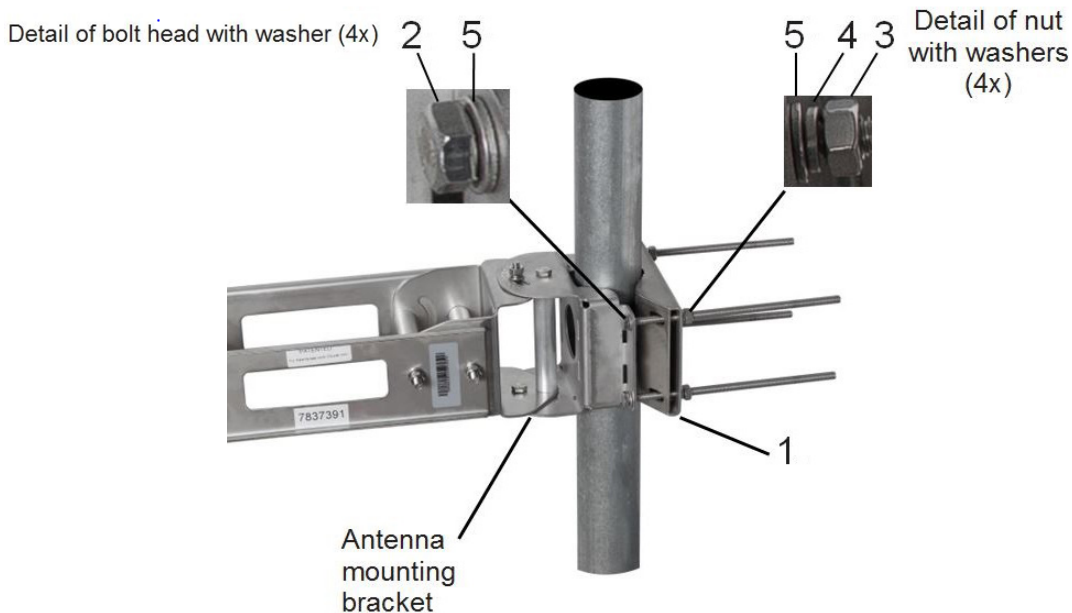

1. Insert the four bolts M6 (2) with four of the plain washers (5) into the antenna mounting bracket (see detailed illustration of bolt head).
2. Insert the pole mounting bracket into these four bolts and place the plain & spring washers (4&5) and the M6 nuts (3) over each bolt (detailed illustration).
3. Tighten the four M6 nuts observing the specified torque of 12 Nm.
4. Hang in the safety wire (6) and attach it to a suitable structure for fall protection.

1.9. Outdoor Installation

Note: For outdoor use we recommend removing the plugs from the drain holes if the antenna is exposed to high humidity or rainfall.

NOTICE

: Do not remove the plugs if the antenna is mounted other than bottom down, that means the drain holes showing to the ground. For the top and bottom of the antenna observe the arrow labeling at the rear side. Otherwise water might penetrate into and, therefore, damage the antenna.

Remove the plugs from the drain holes at the bottom of the antenna with a knife or a flat screwdriver. The below indicates the location of the drain holes, design and/or size of the antenna may be different.

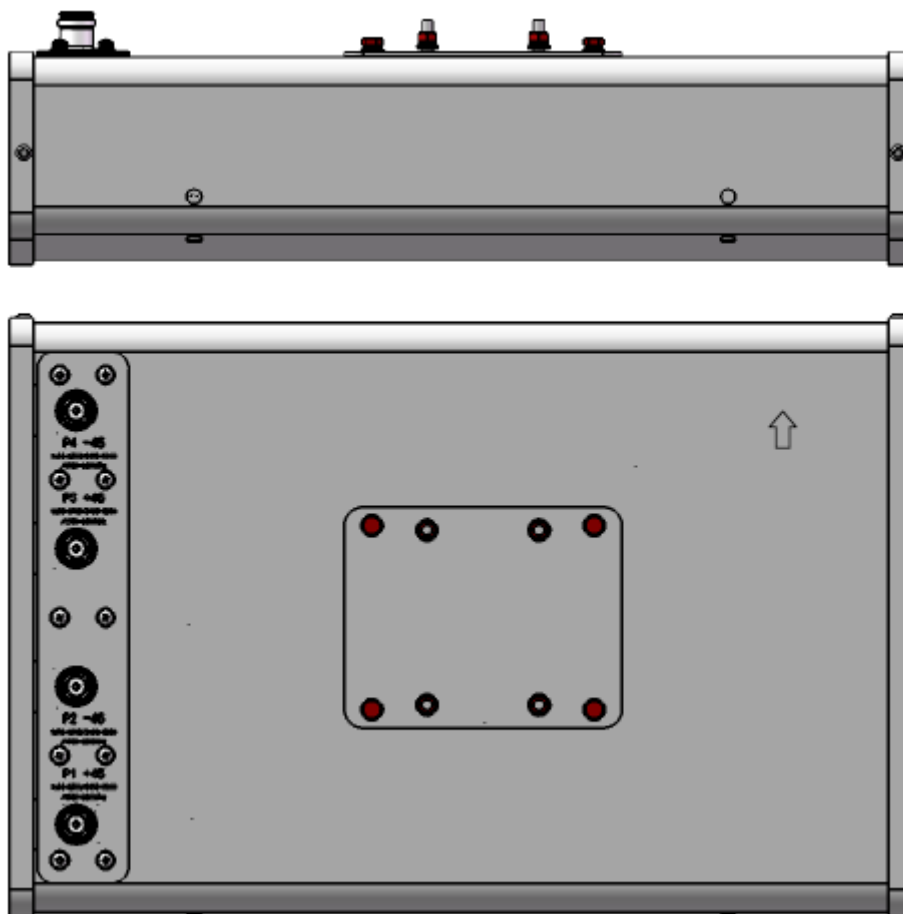

2. Contacting ANDREW

The following sections tell you how to contact ANDREW® for additional information or for assistance.

2.1. Technical Support

The following sections tell you how to contact the ANDREW Technical Support team. Support is available 7 days a week, 24 hours a day.

Telephone Helplines

Use the following Helpline telephone numbers to get live support, 24 hours a day.

24X7 +1 888-297-6433 (Toll free for U.S. and Canada)

EMEA 8:00-17:00 (UTC +1) + 800 73732837 (Toll free for parts of EMEA and Australia)
+ 49 909969333 (Toll charge incurred)

Calls to an EMEA Helpline outside of the 8:00 to 17:00 time frame will be forwarded to the 24x7 Helpline.

Online Support

Click the link below or scan the QR code to the right to submit tickets using the online [Technical Support Form](#).



2.2. Waste Electrical and Electronic Equipment Recycling

The ANDREW focus on building a sustainable future includes protecting and preserving the environment. The challenges our planet now faces — including climate change, resource depletion and pollution — require urgent attention and innovative solutions.

We believe that sustainable practices are key to addressing these challenges and ensuring a healthier environment for future generations. Through responsible actions, eco-friendly initiatives and cutting-edge technologies, ANDREW is empowering businesses and communities to reduce their environmental impact. Join us in making a meaningful difference.

To learn more, scan the QR code to the right or click the link below:

<https://www.andrew.com/sustainability/environment/weee/>



2.3. Technical Training

1. To access training on the online technical training site, please click <https://www.andrew.com/support/training/> or scan the QR code to the right:
2. From here you can see course catalogs, training calendars, and visit the training portal that lets you register for online and instructor-led courses and take online courses.
3. Instructor-led courses are conducted in North America and Europe. Before choosing a course, please verify the region.
4. For training related questions, please contact us:
icn_training@andrew.com



2.4. Accessing User Documentation

1. Access to the Customer Portal requires a user account. If you don't have an account:
 - Visit My ANDREW at <https://www.andrew.com/membership> or by scanning the QR code to the right.
 - Click “New user registration” and follow the prompts.
 - After you have registered in My ANDREW, click the **Request access** button for the **Customer Portals**.
 - After having done the request, it might take several days to get approved. Then, you can select the **Indoor Wireless Resource Center for ANDREW** from the list of applications.
2. To go directly to the portal, where you can access the DAS-user documentation, scan the QR Code to the right.
Alternatively, visit My ANDREW (see above) and use the **Indoor Wireless Resource Center for ANDREW** application.
3. In Tools and Documentation, search by product, document category, or title.
4. Click on the title of any document to open it.

