

- 1.0 GENERAL NOTES
- 1.1 ALL METRIC DIMENSIONS ARE IN BRACKETS [X.X]
- 1.2 FEATURES CRITICAL TO QUALITY ARE INDICATED IN ROUNDED BOX (X.X)
- 2.0 DESIGN NOTES
- 3.0 MANUFACTURING/SPECIAL REQUIREMENTS
- 4.0 TEST
- 5.0 PACKAGING
- 5.1 PACKAGING MUST BE AGREED TO IN WRITING BY ANDREW PRIOR TO MASS-PRODUCTION APPROVAL.
- 5.2 PARTS ARE TO BE PACKAGING IN A MANNER OT PREVENT DAMAGE DURING SHIPMENT & STORAGE.
- 5.3 PACKAGING TO ADHERE TO ALL ANDREW, LOCAL & FOREIGN (WHERE APPLICABLE) SHIPPING REQUIREMENTS.
- 5.4 PACKAGING & PARTS TO BE FREE OF ALL CONTAMINANTS INCLUDING PAPER FROM BOX, DIRT, DUST, OILS, MOLD RELEASE, DETERGENT AND ALL OTHER FOREIGN MATERIALS.

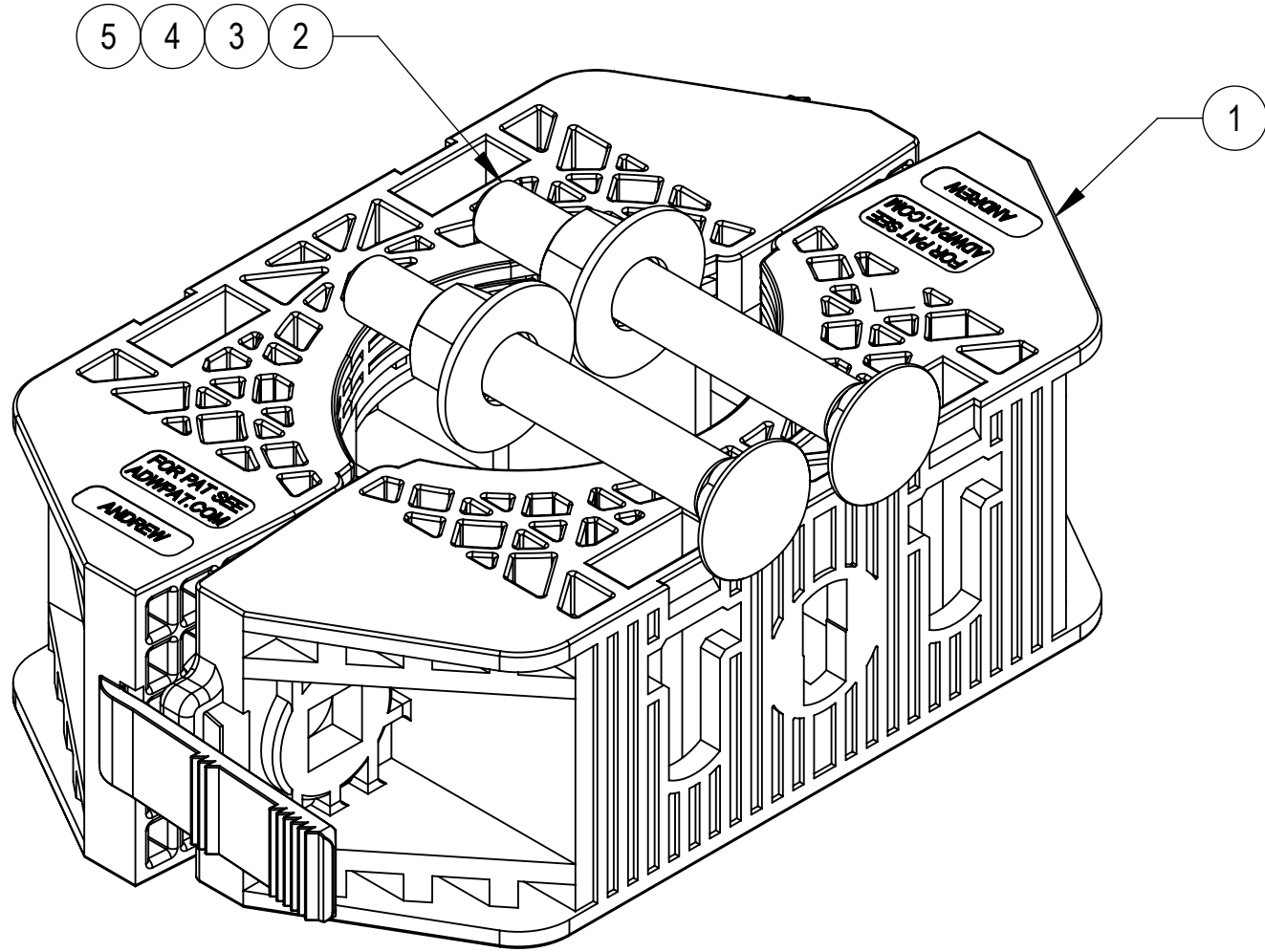

COMPONENT PART NUMBERS PROVIDED FOR ASSEMBLY PURPOSES;  
INDIVIDUAL COMPONENTS MAY BE SHIPPED AS PARTS WITHIN AN INCLUDED KIT.

ITEM	PART NO.	DESCRIPTION	QTY.	WEIGHT	NOTE NO.
1	PGCS-1000	CLAMP,FRONT-REAR, POLYMER 4CP	2	0.33 LBS	
2	9615-15	BOLT,CARRIAGE,3/8-16,3,STL GALV	2	0.12 LBS	
3	GWL-03	3/8" GALV LOCK WASHER	2	0.01 LBS	
4	GN-03	3/8" GALV HEX NUT	2	0.02 LBS	
5	GWF-03	3/8" GALV FLAT WASHER	2	0.01 LBS	

DENSITY		lbs/in³
MASS	0.75	lbs
VOLUME	17.14	in³
SURFACE AREA	261.10	in²
HEIGHT	2.65"	
LENGTH	6.55"	
WIDTH	3.85"	

Confidential



**ANDREW**® an Amphenol company

TOLERANCES				SAP MATERIAL MASTER				
1 PLACE .X[X] ± 0.2[6.3]		3 PLACE .XXX[X] ± 0.060[1.5]		PGP-CS02				
2 PLACE .XX[X] ± 0.12[3.0]		ANGLES ± 2°						
FINISH				MATERIAL				
UNLESS OTHERWISE SPECIFIED DIMENSIONS ARE IN INCHES INTERPRET PER ANSI Y 14.5M-1994		NAME	DATE	PG PREMIUM,CBL-SUPPORT,2-HOLE				
	CE	YMENG	13JUN23					
	RW	JL1183	06/11/2025					
	AD	JX1030	06/11/2025	SCALE 1:2		DOCUMENT NO.  PGP-CS02		
	RE	JL1183	06/11/2025					
	ECN 50103287AMO							
	SIZE	Auth Group	INSL	MODEL		DRAWING		
C			VERSION	STATUS	REVISION	VERSION	STATUS	REVISION
			02	RE	C	02	RE	C